

## Sawtooth Ladder



12" finished quilt block

# Sawtooth Ladder

## Sample Quilt Layouts

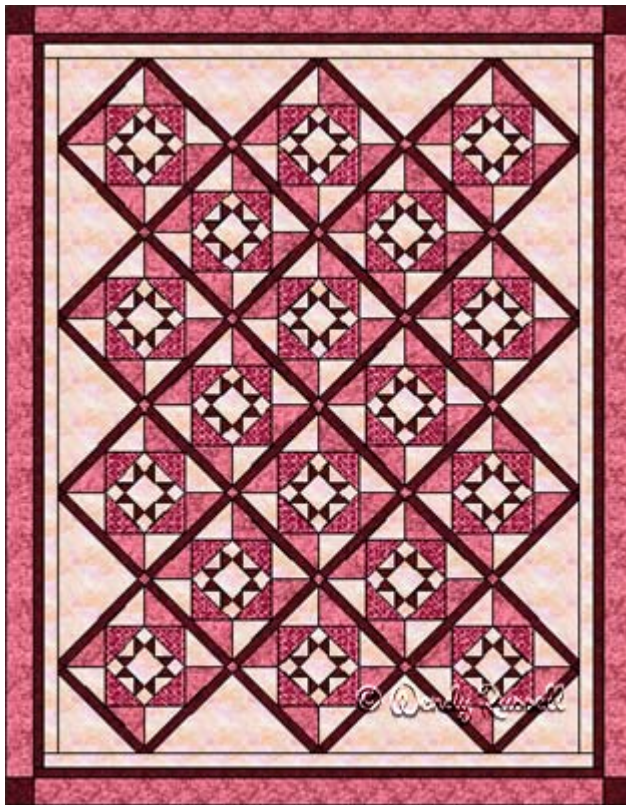

Fabric Placement



## Sawtooth Ladder

12" finished quilt block

### How-to Notes







Bisect square on one diagonal



Bisect square on both diagonals

\*All seam allowances are ¼" unless noted otherwise

<b>1</b>		<p><b>Background fabric 1</b></p> <p>Cut centre square 3 ½"</p> <p>Cut 4 squares each 2"</p> <p>Cut 1 square 4 ¼" and bisect on both diagonals</p> <p>Cut 1 square 7 ¼" and bisect on both diagonals</p>
<b>2</b>		<p><b>Fabric 2</b></p> <p>Cut 1 square 7 ¼" and bisect on both diagonals</p>
<b>3</b>		<p><b>Fabric 3</b></p> <p>Cut 1 square 7 ¼" and bisect on both diagonals</p>
<b>4</b>		<p><b>Fabric 4</b></p> <p>Cut 4 squares each 2 ⅜" and bisect on one diagonal</p>



# Sawtooth Ladder

1

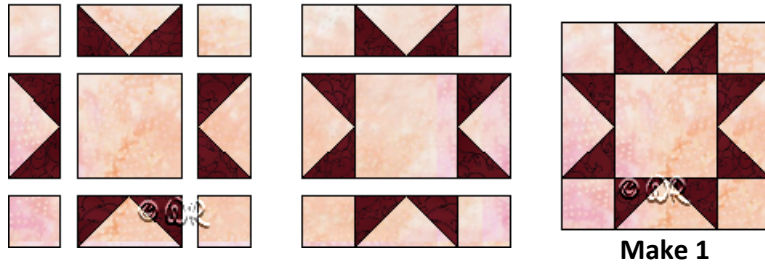

2

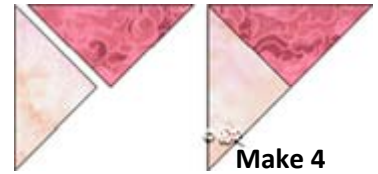

3

