

Patchwork Square

Free Quilt Block Pattern

Pink Magnolia

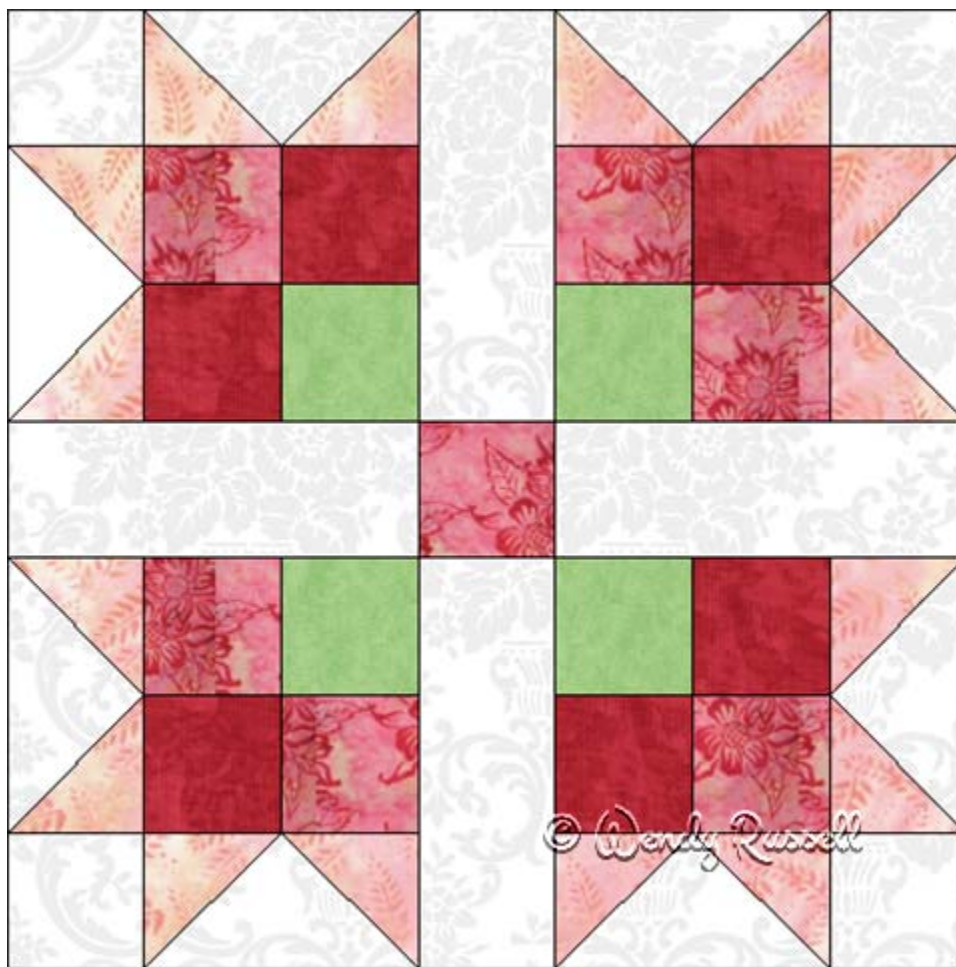

14" finished quilt block

10 ½" finished quilt block

7" finished quilt block

Patchwork Square

Free Quilt Block Pattern

Pink Magnolia

14" finished quilt block

Fabric Placement

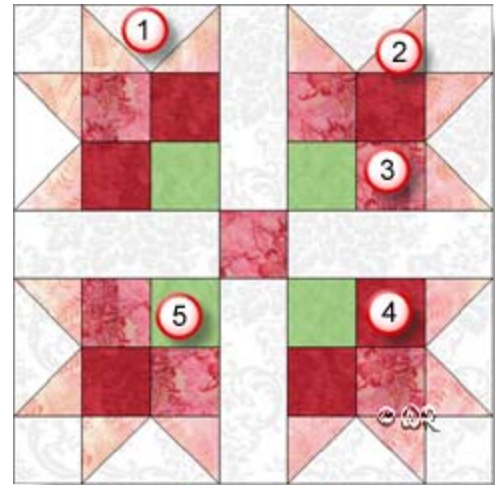

How-to Notes



Bisect square on one diagonal



Bisect square on both diagonals

*All seam allowances are 1/4" and included in cutting measurements unless noted otherwise

1



Fabric 1

Cut 4 squares 2 1/2"
Cut 4 rectangles 2 1/2" x 6 1/2"
Cut 2 squares 5 1/4" and bisect on both diagonals

2



Fabric 2

Cut 8 squares 2 7/8" and bisect on one diagonal

3



Fabric 3

Cut 7 squares 2 1/2"

4



Fabric 4

Cut 6 squares 2 1/2"

5



Fabric 5

Cut 4 squares 2 1/2"

Patchwork Square

Free Quilt Block Pattern

Pink Magnolia

10 1/2" finished quilt block

Fabric Placement

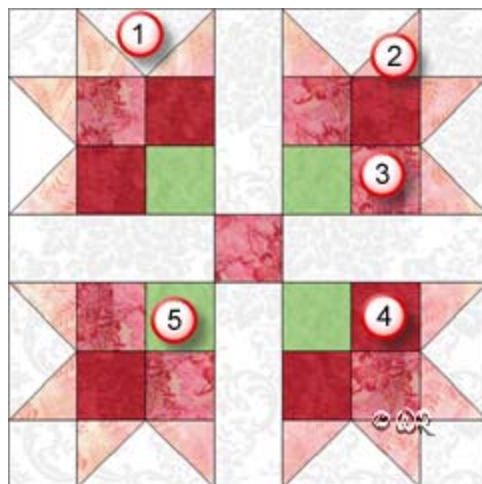

How-to Notes



Bisect square on one diagonal



Bisect square on both diagonals

*All seam allowances are 1/4" and included in cutting measurements unless noted otherwise

1



Fabric 1

Cut 4 squares 2"
Cut 4 rectangles 2" x 5"
Cut 2 squares 4 1/4" and bisect on both diagonals

2



Fabric 2

Cut 8 squares 2 3/8" and bisect on one diagonal

3



Fabric 3

Cut 7 squares 2"

4



Fabric 4

Cut 6 squares 2"

5



Fabric 5

Cut 4 squares 2"

Patchwork Square

Free Quilt Block Pattern

Pink Magnolia

7" finished quilt block

Fabric Placement

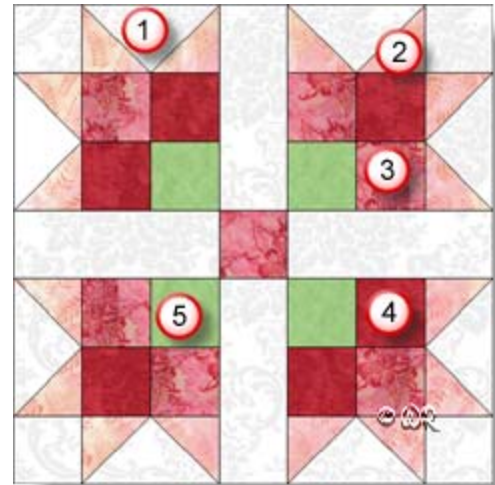

How-to Notes



Bisect square on one diagonal



Bisect square on both diagonals

*All seam allowances are 1/4" and included in cutting measurements unless noted otherwise

1



Fabric 1

Cut 4 squares 1 1/2"
Cut 4 rectangles 1 1/2" x 3 1/2"
Cut 2 squares 3 1/4" and bisect on both diagonals

2



Fabric 2

Cut 8 squares 1 7/8" and bisect on one diagonal

3



Fabric 3

Cut 7 squares 1 1/2"

4



Fabric 4

Cut 6 squares 1 1/2"

5



Fabric 5

Cut 4 squares 1 1/2"

Patchwork Square

Free Quilt Block Pattern

Pink Magnolia

Method

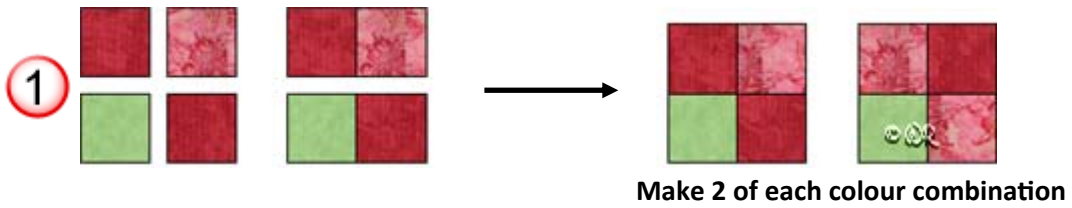

Method

