

## Easter Lily

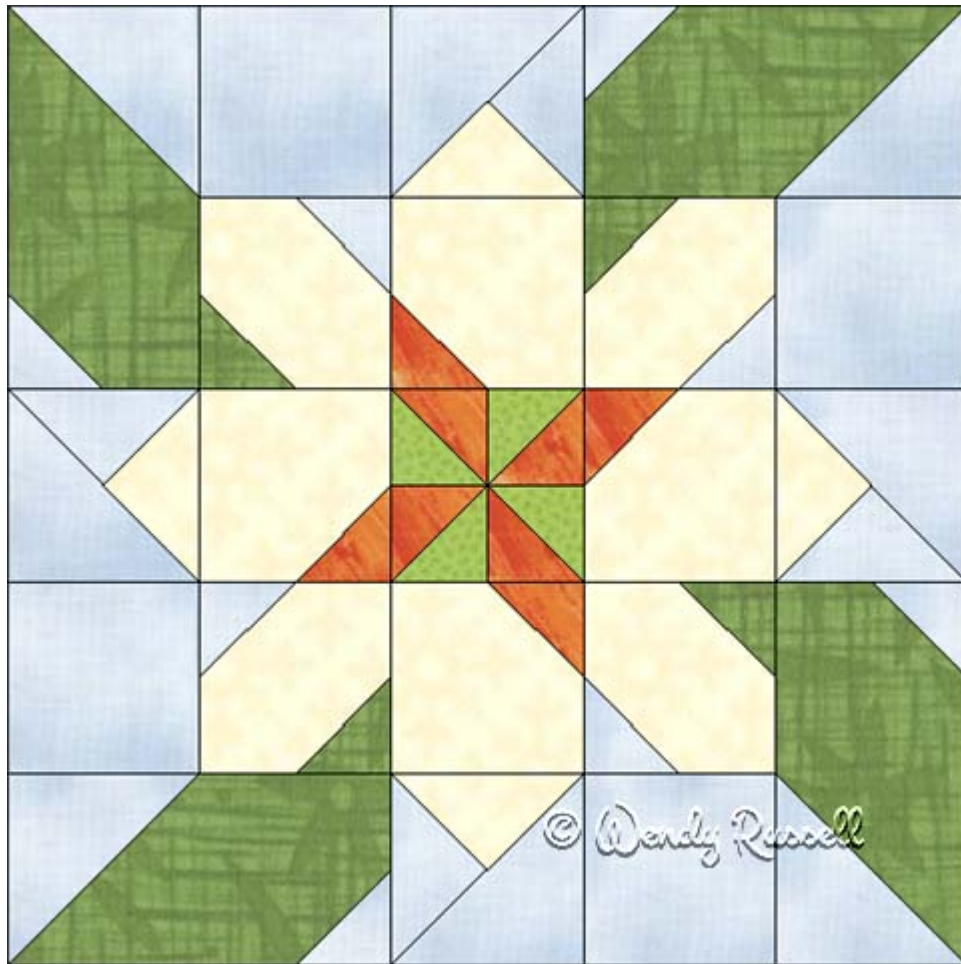

**15" finished quilt block**

**10" finished quilt block**

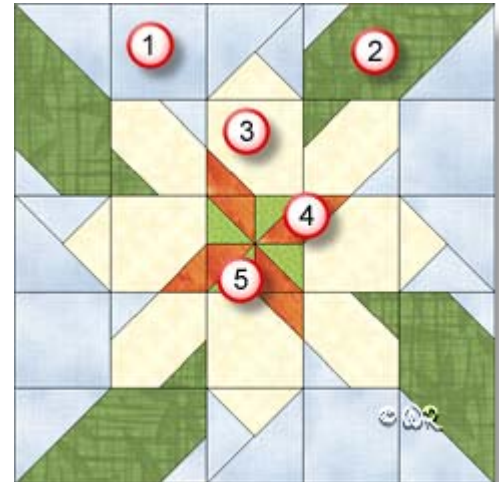

## Easter Lily

15" finished quilt block

### How-to Notes







Bisect square on one diagonal



Bisect square on both diagonals

\*All seam allowances are  $\frac{1}{4}$ " unless noted otherwise

<b>1</b>		<p><b>Fabric 1</b></p> <p>Cut 8 squares 2" (for "sew and flip" triangles)</p> <p>Cut 8 squares <math>3\frac{1}{2}</math>" (4 will be used for "sew and flip" triangles)</p> <p>Cut 2 squares <math>3\frac{7}{8}</math>" and bisect on one diagonal</p> <p>Cut 1 square <math>4\frac{1}{4}</math>" and bisect on both diagonals</p>
<b>2</b>		<p><b>Fabric 2</b></p> <p>Cut 4 rectangles <math>3\frac{1}{2}</math>" x <math>6\frac{1}{2}</math>"</p> <p>Cut 4 squares 2" (for "sew and flip" triangles)</p>
<b>3</b>		<p><b>Fabric 3</b></p> <p>Cut 8 squares <math>3\frac{1}{2}</math>"</p> <p>Cut 1 square <math>4\frac{1}{4}</math>" and bisect on both diagonals</p>
<b>4</b>		<p><b>Fabric 4</b></p> <p>Cut 2 squares <math>2\frac{3}{8}</math>" and bisect on one diagonal</p> <p>Cut 4 squares 2" (for "sew and flip" triangles)</p>
<b>5</b>		<p><b>Fabric 5</b></p> <p>Cut 2 squares <math>2\frac{3}{8}</math>" and bisect on one diagonal</p>

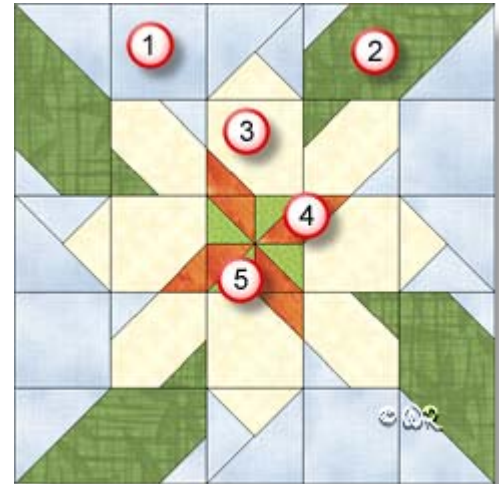

## Easter Lily

10" finished quilt block

### How-to Notes







Bisect square on one diagonal



Bisect square on both diagonals

\*All seam allowances are  $\frac{1}{4}$ " unless noted otherwise

<b>1</b>		<p><b>Fabric 1</b></p> <p>Cut 8 squares <math>1\frac{1}{2}</math>" (for "sew and flip" triangles)            Cut 8 squares <math>2\frac{1}{2}</math>" (4 will be used for "sew and flip" triangles)            Cut 2 squares <math>2\frac{7}{8}</math>" and bisect on one diagonal            Cut 1 square <math>3\frac{1}{4}</math>" and bisect on both diagonals</p>
<b>2</b>		<p><b>Fabric 2</b></p> <p>Cut 4 rectangles <math>2\frac{1}{2}</math>" x <math>4\frac{1}{2}</math>"            Cut 4 squares <math>1\frac{1}{2}</math>" (for "sew and flip" triangles)</p>
<b>3</b>		<p><b>Fabric 3</b></p> <p>Cut 8 squares <math>2\frac{1}{2}</math>"            Cut 1 square <math>3\frac{1}{4}</math>" and bisect on both diagonals</p>
<b>4</b>		<p><b>Fabric 4</b></p> <p>Cut 2 squares <math>1\frac{7}{8}</math>" and bisect on one diagonal            Cut 4 squares <math>1\frac{1}{2}</math>" (for "sew and flip" triangles)</p>
<b>5</b>		<p><b>Fabric 5</b></p> <p>Cut 2 squares <math>1\frac{7}{8}</math>" and bisect on one diagonal</p>

## Easter Lily

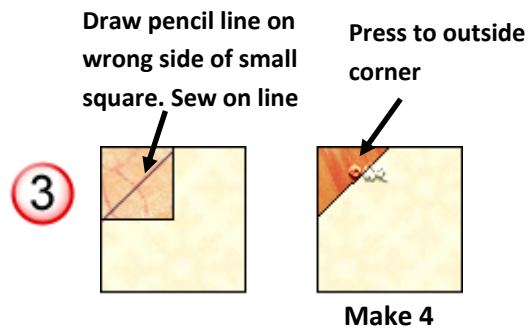
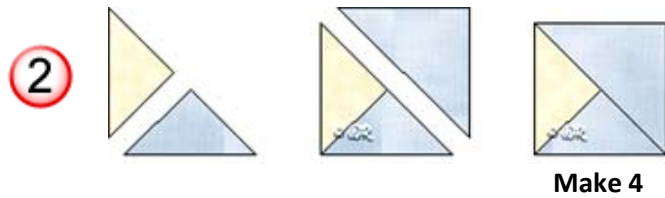
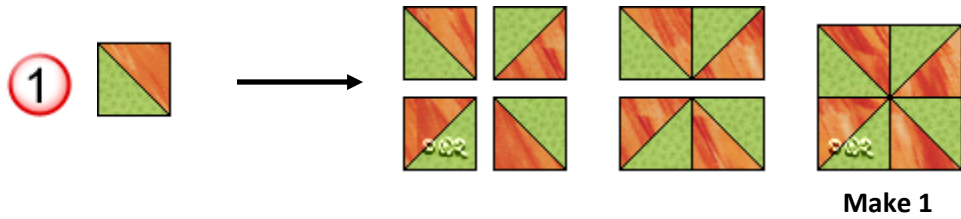

Repeat process in Step 3 with two opposite corners

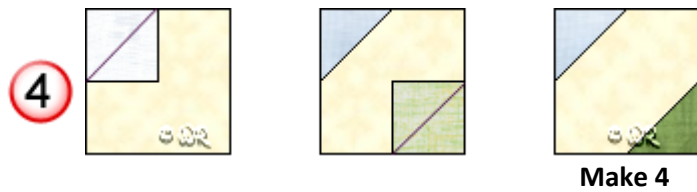

*Continued on next page* →

## Easter Lily

### “Leaf” Patches — Make 4

5

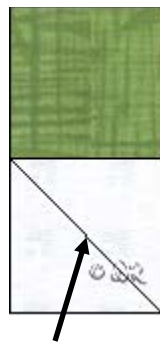

1. Draw pencil line, corner to corner on wrong side of square

2. Sew on pencil line



3. Flip fabric to corner

4. Repeat process for small square in opposite corner



5. Completed, pressed patch

*\*You may wish to trim excess fabric behind visible triangles*

## Easter Lily

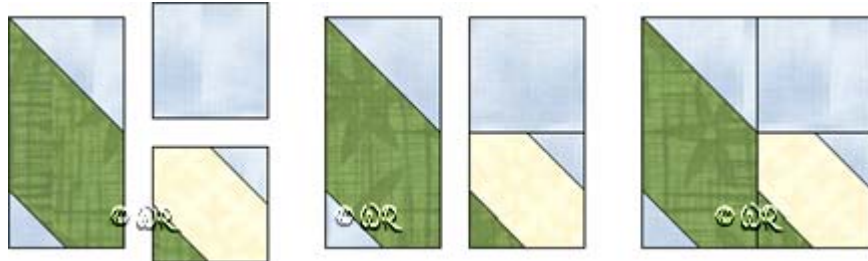

Make 4

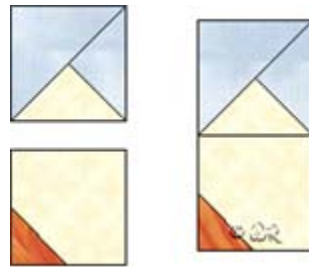

Make 4

