

# Aunt Dinah

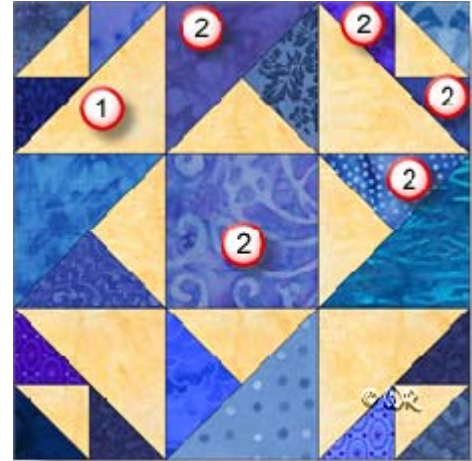

12" finished quilt block  
9" finished quilt block  
6" finished quilt block

Fabric Placement



## Aunt Dinah

12" finished quilt block

### How-to Notes



Bisect square on one diagonal



Bisect square on both diagonals

\*All seam allowances are 1/4" unless noted otherwise

1



### Background fabric 1

Cut 2 squares 4 7/8" and bisect on one diagonal  
 Cut 2 squares 2 7/8" and bisect on one diagonal  
 Cut 1 square 5 1/4" and bisect on **both** diagonals

2



**Note:** You may wish to use additional fabrics to attain a more scrappy appearance and have extra triangles left over for more blocks.

### Assorted contrasting fabrics (or use a single fabric)

Cut 6 squares 2 7/8" and bisect on one diagonal (yield 12 triangles)  
 Cut 2 squares 4 7/8" and bisect on one diagonal (yield 4 triangles)  
 Cut 1 square 5 1/4" and bisect on **both** diagonals (yield 4 triangles)  
 Cut centre square 4 1/2"

Fabric Placement

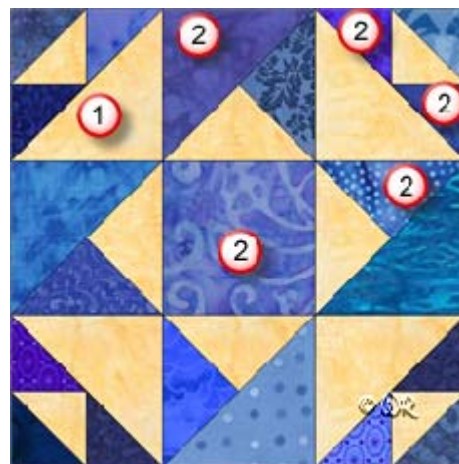

## Aunt Dinah

9" finished quilt block

### How-to Notes



Bisect square on one diagonal



Bisect square on both diagonals

\*All seam allowances are 1/4" unless noted otherwise

1



### Background fabric 1

Cut 2 squares 3 7/8" and bisect on one diagonal  
 Cut 2 squares 2 3/8" and bisect on one diagonal  
 Cut 1 square 4 1/4" and bisect on **both** diagonals

2



**Note:** You may wish to use additional fabrics to attain a more scrappy appearance and have extra triangles left over for more blocks.

### Assorted contrasting fabrics (or use a single fabric)

Cut 6 squares 2 3/8" and bisect on one diagonal (yield 12 triangles)  
 Cut 2 squares 3 7/8" and bisect on one diagonal (yield 4 triangles)  
 Cut 1 square 4 1/4" and bisect on **both** diagonals (yield 4 triangles)  
 Cut centre square 3 1/2"

Fabric Placement

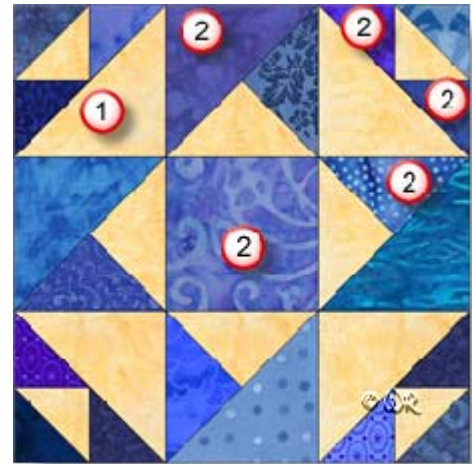

## Aunt Dinah

6" finished quilt block

### How-to Notes



Bisect square on one diagonal



Bisect square on both diagonals

\*All seam allowances are 1/4" unless noted otherwise

1



### Background fabric1

Cut 2 squares 2 7/8" and bisect on one diagonal  
 Cut 2 squares 1 7/8" and bisect on one diagonal  
 Cut 1 square 3 1/4" and bisect on **both** diagonals

2



**Note:** You may wish to use additional fabrics to attain a more scrappy appearance and have extra triangles left over for more blocks.

### Assorted contrasting fabrics (or use a single fabric)

Cut 6 squares 1 7/8" and bisect on one diagonal (yield 12 triangles)  
 Cut 2 squares 2 7/8" and bisect on one diagonal (yield 4 triangles)  
 Cut 1 square 3 1/4" and bisect on **both** diagonals (yield 4 triangles)  
 Cut centre square 2 1/2"

## Aunt Dinah

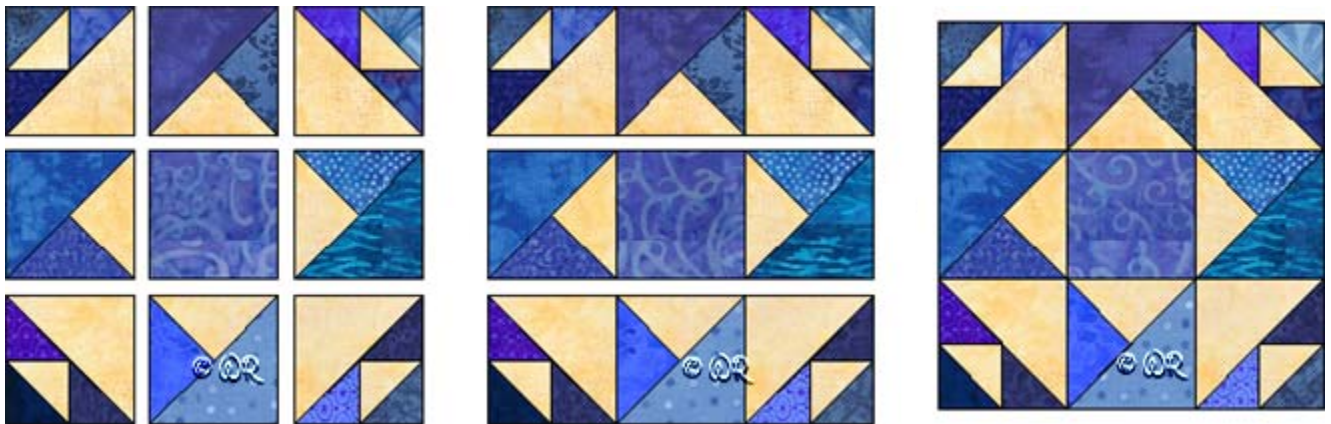
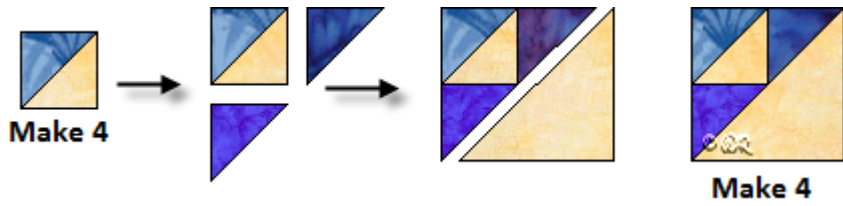
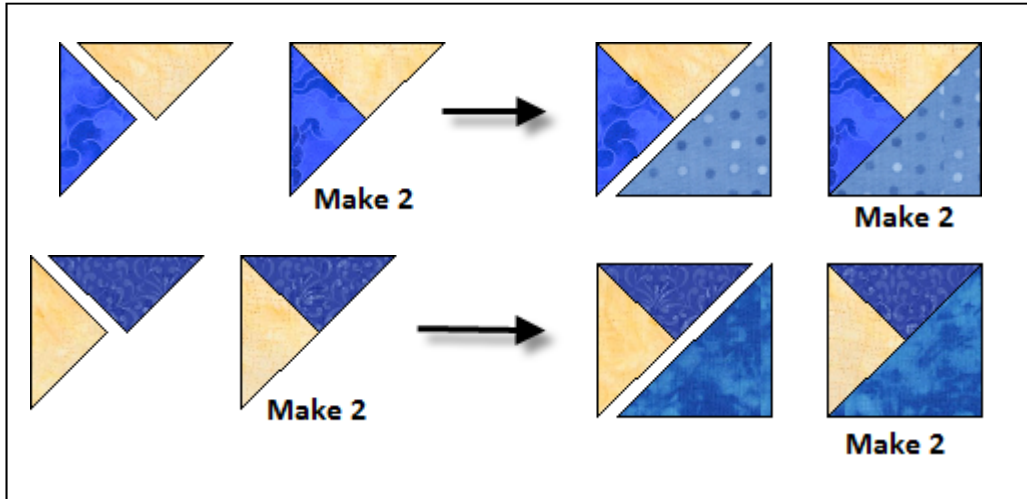

# Aunt Dinah

## Sample Quilt Layouts

